

液压手动泵：

液压手动泵是将手动机械能转化为液体压力能的小型液压泵站，配备不同直径的油缸可获得不同压力吨位，配备专有的机具，可进行起重、弯曲、校直、成型、试压等作业。该油泵设计先进，超高压，大排量，操作简单，原动力为手动，因而用途极为广泛，是各行业得力助手。

Hydraulic Hand Pump:

Hydraulic hand pump manually mechanical energy is converted into liquid pressure can be a small hydraulic pump stations, equipped with fuel tanks of different diameters and different pressures available tonnage, equipped with proprietary equipment,using for lifting, bending, alignment ,molding, such as operating pressure testing.

The design of pump is advanced,large capacity, and simple operation, the driving force is the manual force, which uses an extremely broad right-hand man in various economic sectors.



DYB 系列液压扳手：

DYB 系列液压扳手针对高强度，大中型螺栓的紧固拆卸而设计，使用场合广，省力，扭矩准确，主要零部件选用常规超高强度材料制造，结构紧凑，强度高，扭矩大，造价低。

DYB Hydraulic Spanner:

DYB series hydraulic spanner is designed for high-intensity,large and medium-size bolts fastening and disassembly, using for wide occasions, torque is accurate. The main components are made of usual ultrahigh intensity material. The other features is compact structure, high strength,big torque, and low cost.



主要技术参数

Main Specifications Parameters

型号、规格 Type/ Specification	最大扭矩 Max Torque (Nm)	适用最大螺栓、螺母 (对边) Max Bolts/Nuts (mm)	额定最高工作压力 Max Pressure (Mpa)	外形尺寸 Overall Dimension (mm)				整机净重 (N.W.) (Kg)
				L	H	F	f	
DYB 65	5300	M42/65	32	220	210	68	46	8.5
DYB 80	10300	M52/80	42	260	230	76	52	12
DYB 95	19600	M64/95	45	290	260	82	58	18
DYB 115	29700	M80/115	50	340	310	98	69	28

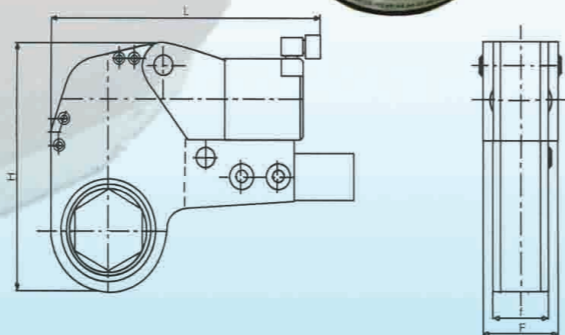

LT 型可退式卡瓦打捞筒：

管子外径处打捞的一种工具。该工具装有密封圈，捞住落鱼后能在较高的泵压下循环钻井液。还可以与震击器配套打捞被卡的落鱼。如果捞住落鱼而不能解卡时，可退出打捞筒起出钻具。从而为处理事故提供了多种选择方案。

特点：

1. 卡瓦与被捞落鱼接触面积大，鱼顶受力均匀，不宜损坏鱼顶。
2. 如落鱼遇卡，工具可以安全退出。
3. 捞筒内装有密封圈，工具入鱼后可以循环洗井。
4. 可以对轻度变形的鱼顶进行修整。

LT Releasing Overshot:

LT releasing overshot is the special external fishing tool used for fishing drill collar,drill pipe,oil tube and other fishes in drilling and work over operation.

1. The contact area of slips and drop fishing is large.The stress on fish top is uniform, and fish top should not be damaged .
2. Once fishing is jammed,the tool may exit safely.
3. Sealing ring is fixed in overshot,and the tools can wash well renewable.
4. May repair and maintain the slight transformative fish top.

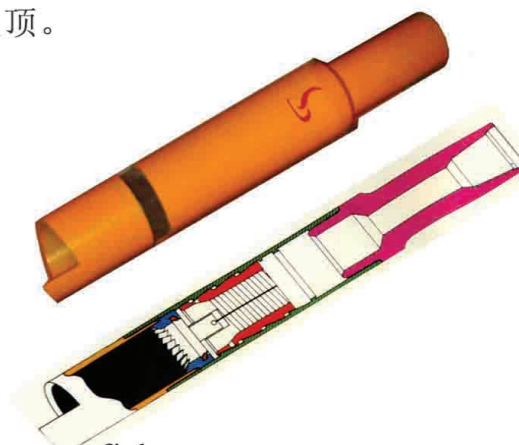

方钻杆旋塞阀：

方钻杆旋塞阀是钻柱循环系统中的手动控制阀，是防止井喷的有效工具之一。方钻杆旋塞阀分上、下钻杆旋塞阀。方钻杆旋塞阀操作非常简单，用专用扳手按指示要求转动 90 度即可实现开和关。在钻井作业中，为了避免井喷恶性事故的发生，均应在方钻杆上下两端安装此旋塞阀。

Kelly Cock Valve:

The kelly cock valve,which is a manually operated ball valve run in the ID of drill string, is one of effective tool for prevention from blow out.The kelly cock is divided into upper and lower kelly cock.The kelly cock valve features a simple operation,the kelly cock valve can be opened or closed by only turning the special operating spanner at 90 degrees according to indicating direction.During drilling operation,in order to avoid serious well kick or blowout accident,the kelly cock valve shall be connected at upper and lower end of kelly.

